

花明樓地下壹層平面圖

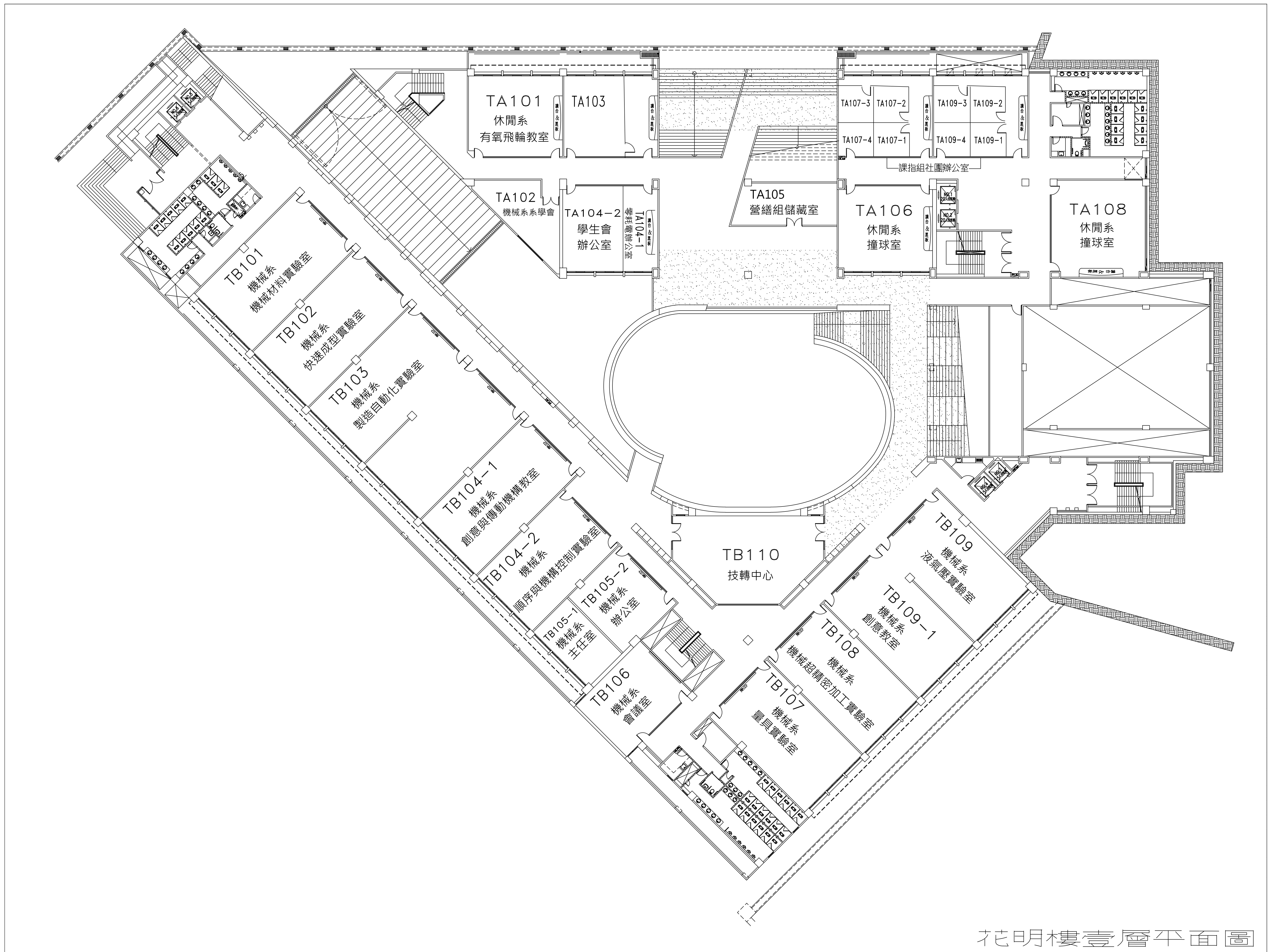

花明樓壹層平面圖

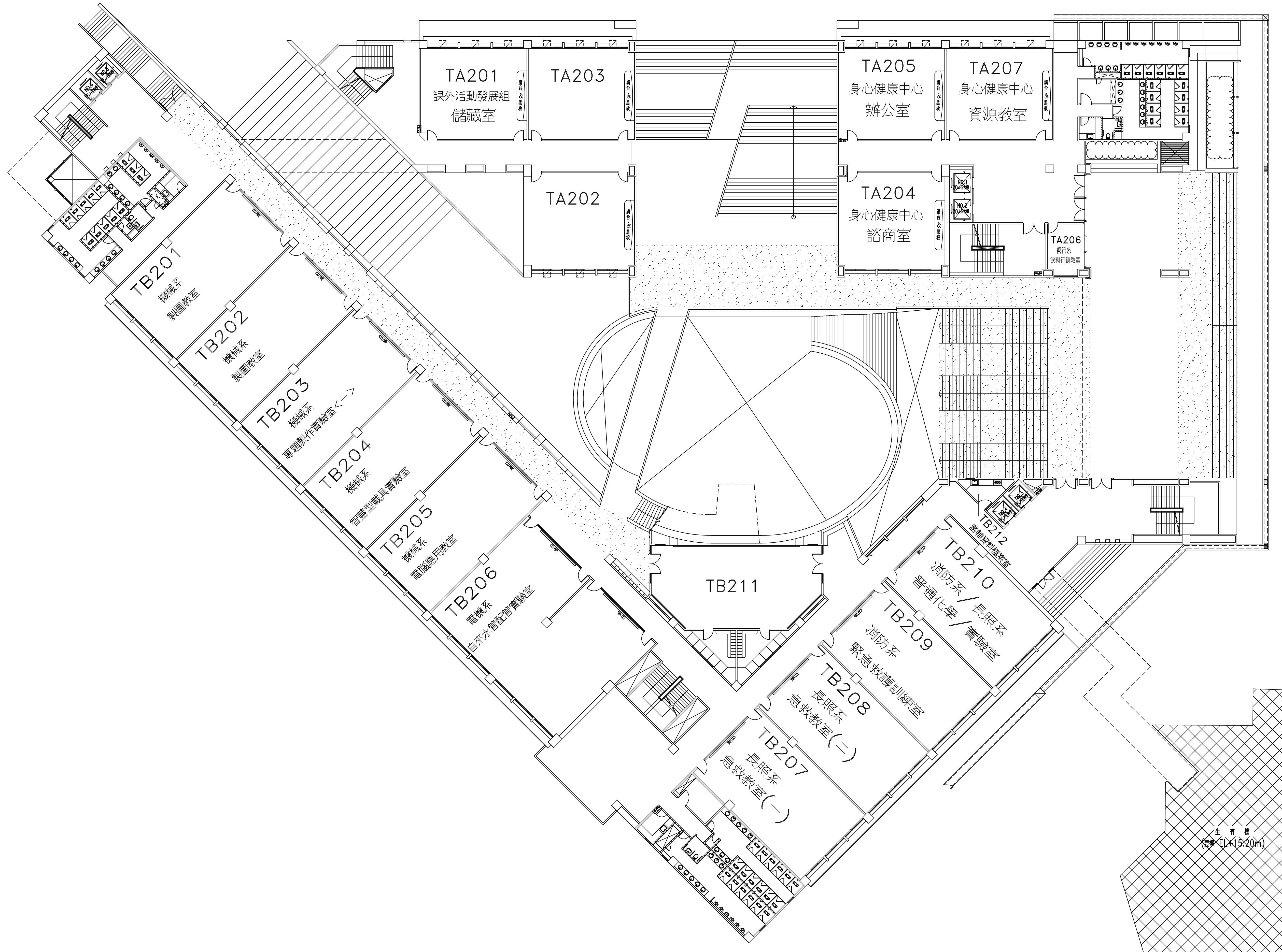

主有樓
(每層EL+15.20m)

花明樓貳層平面圖

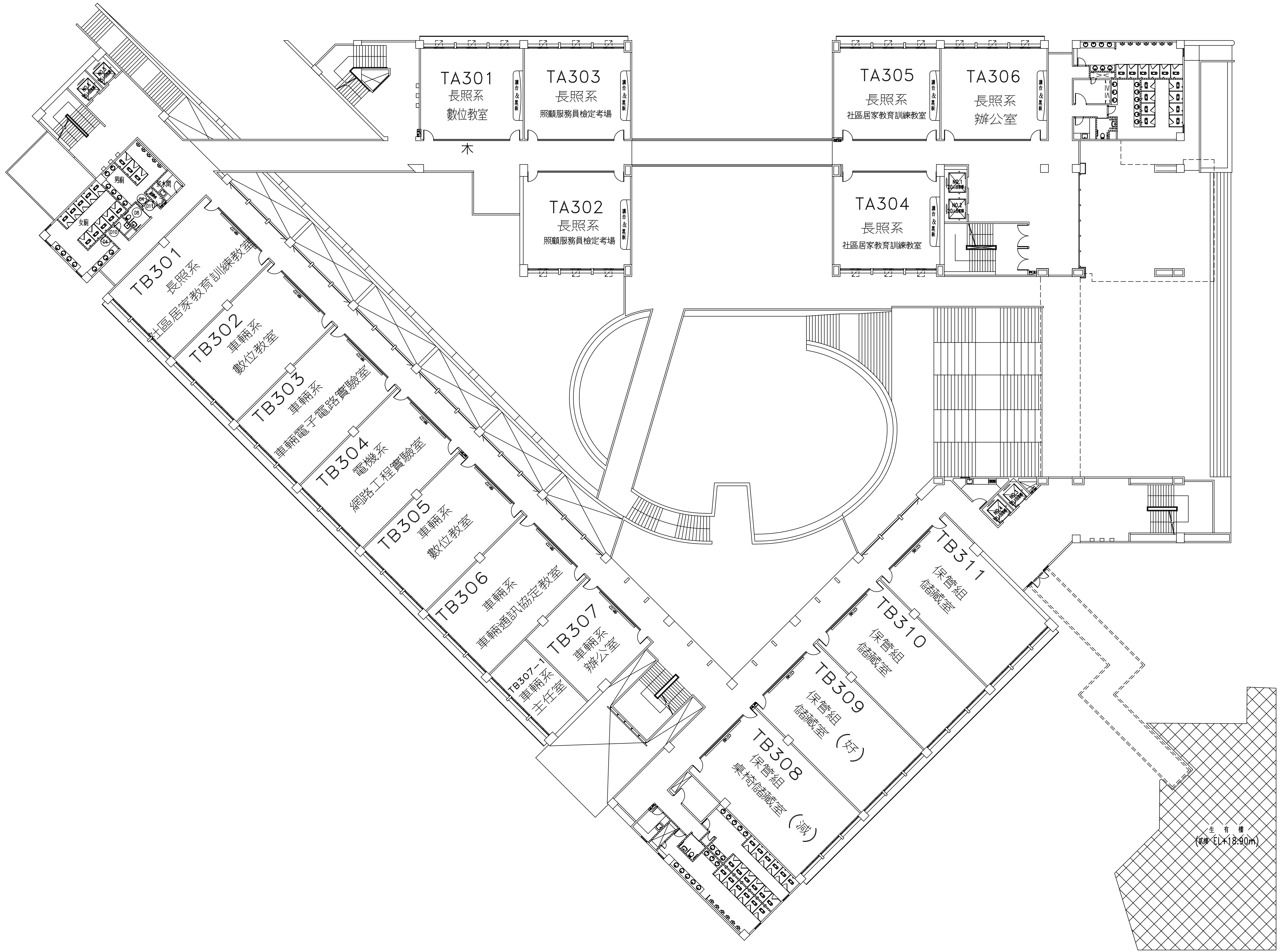

花明樓參層平面圖

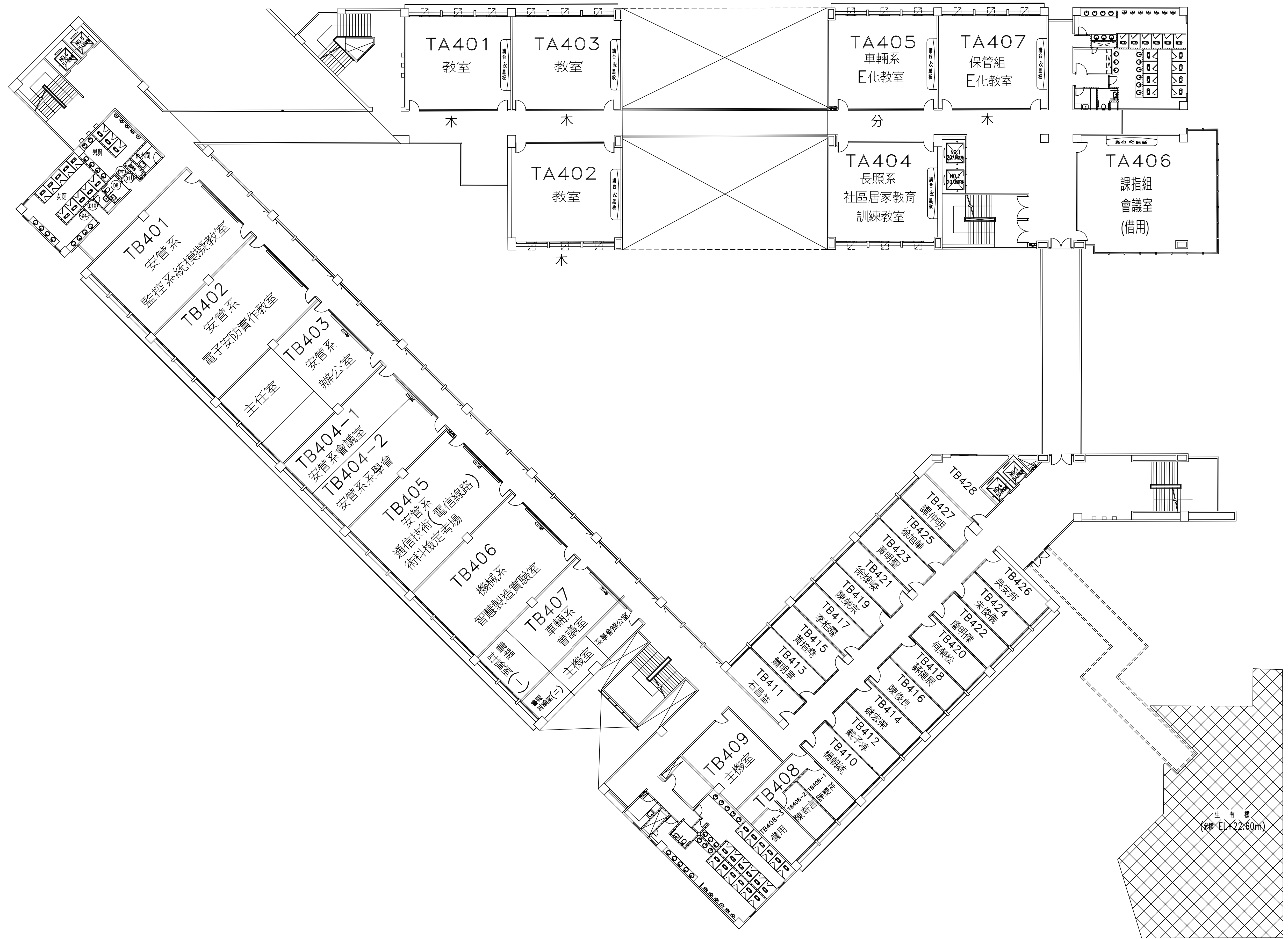

花明樓肆層平面圖



花明樓伍層平面圖

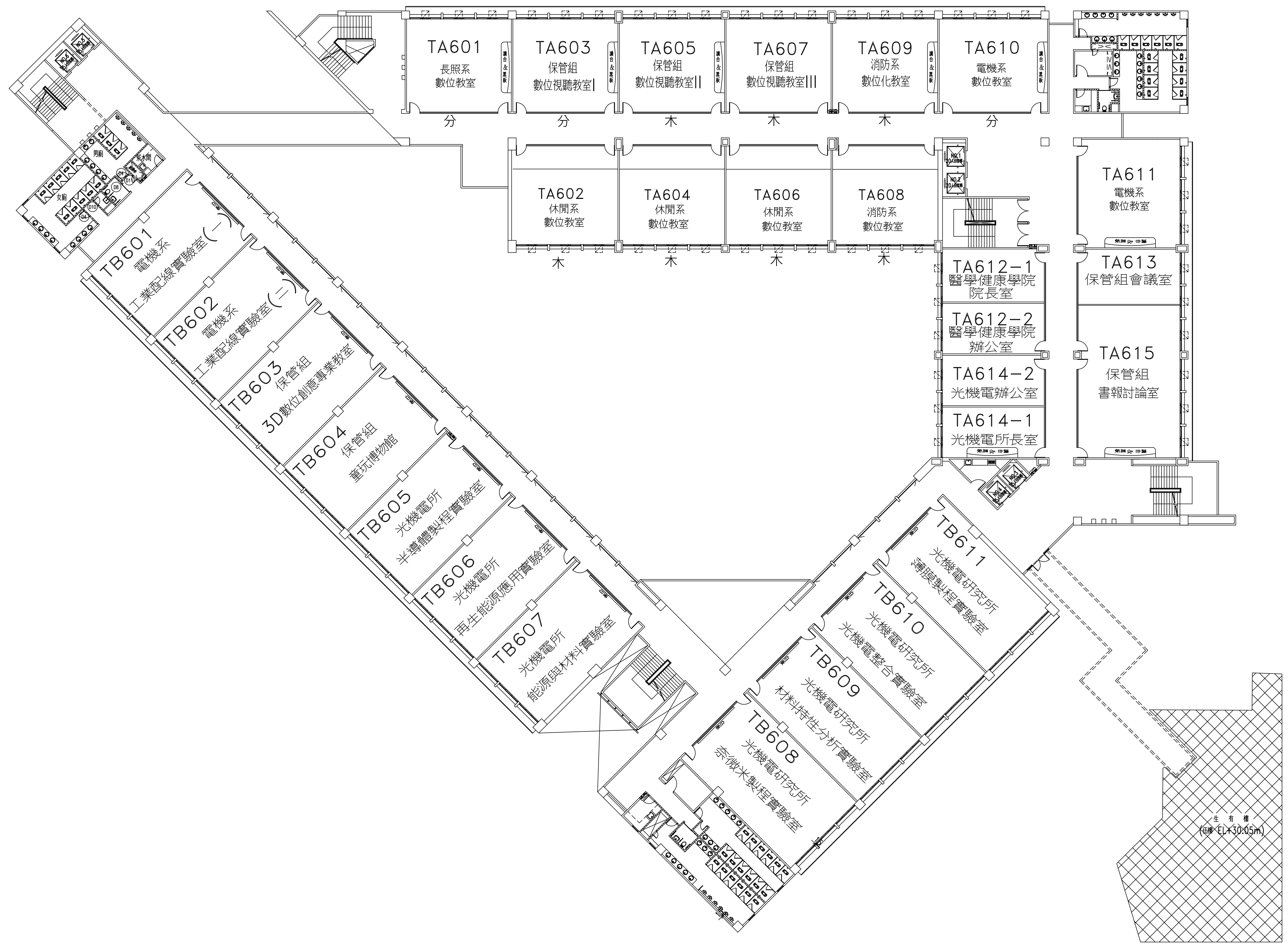

花明樓陸層平面圖

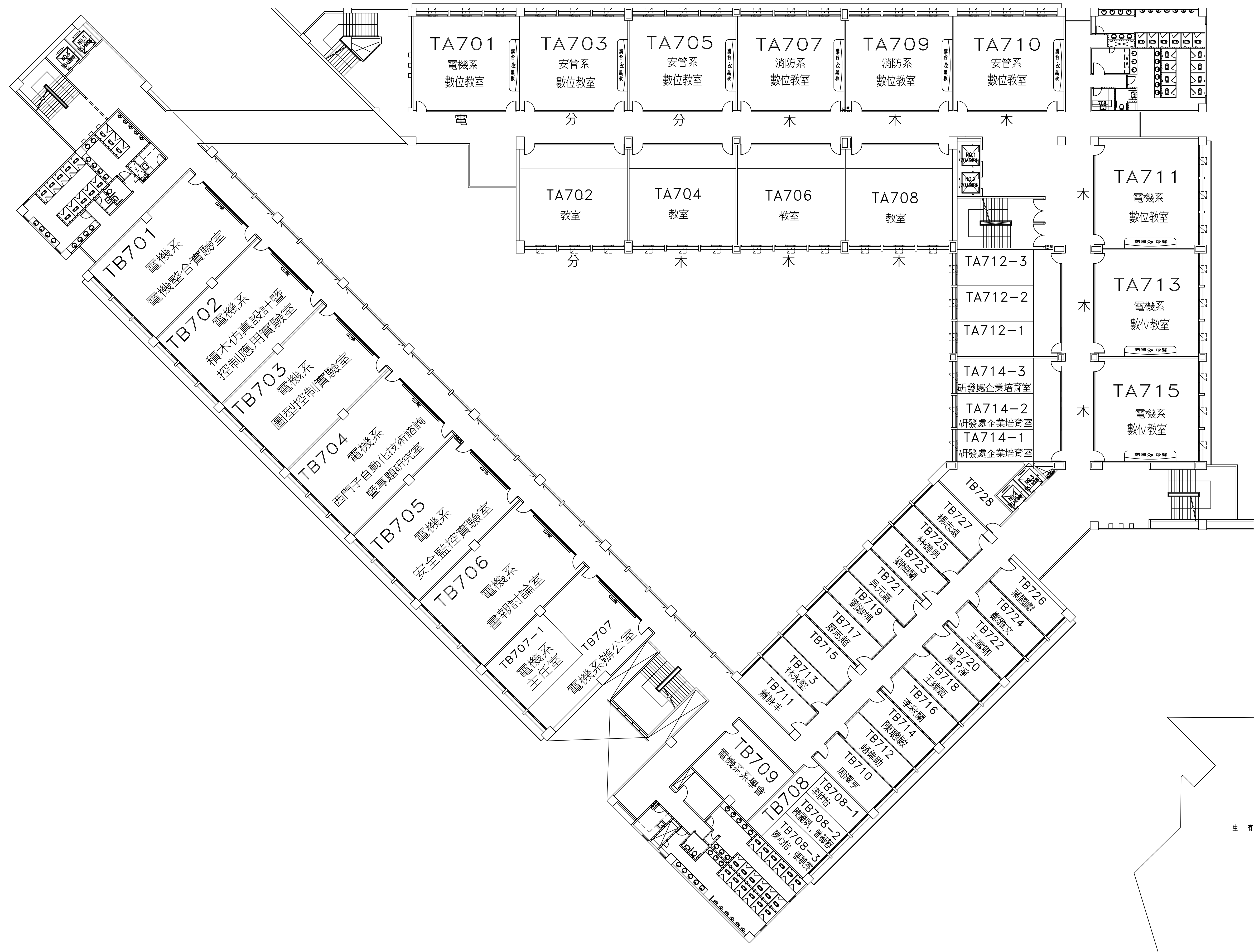

花明樓柒層平面圖

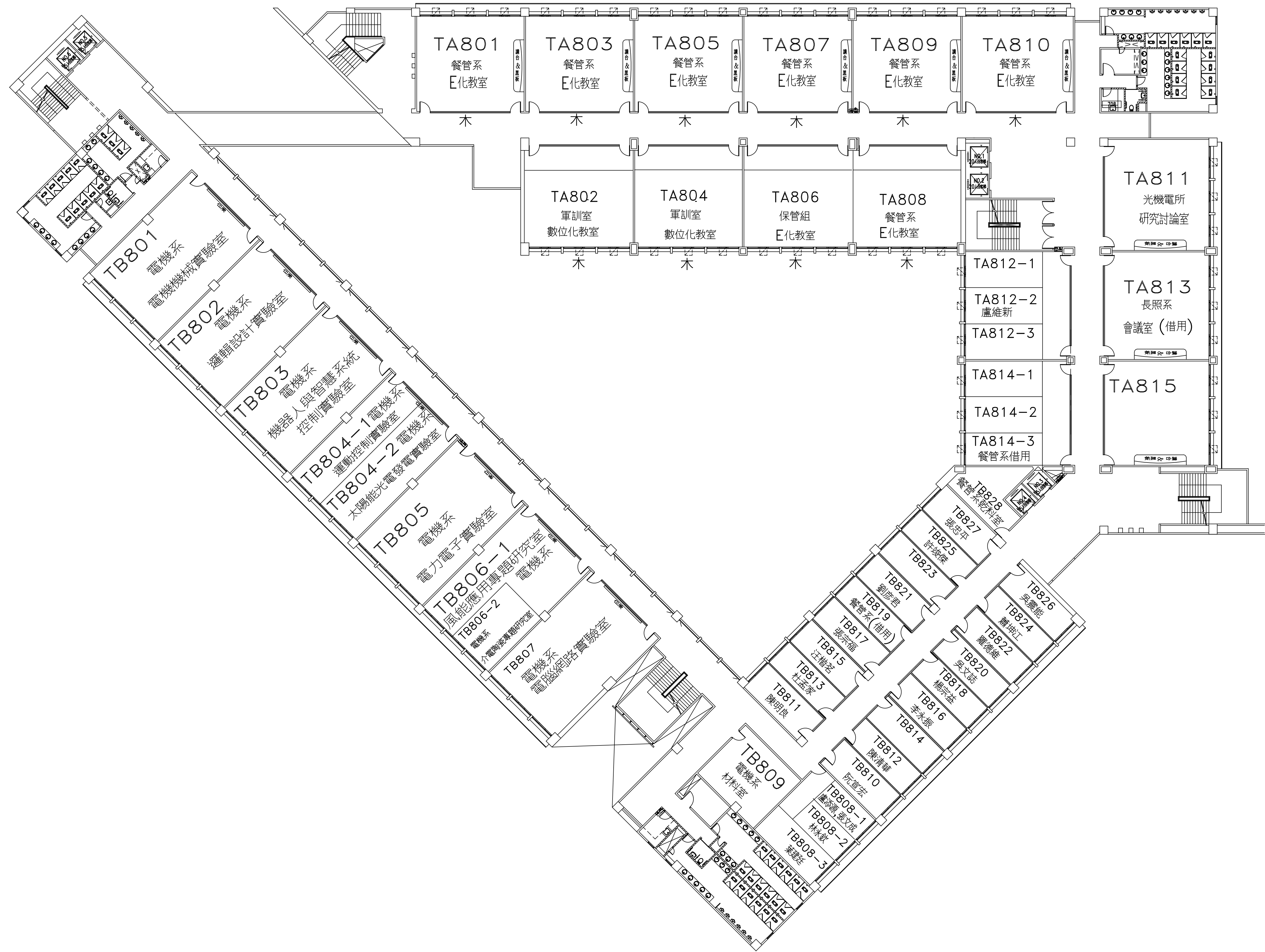

花明樓捌層平面圖

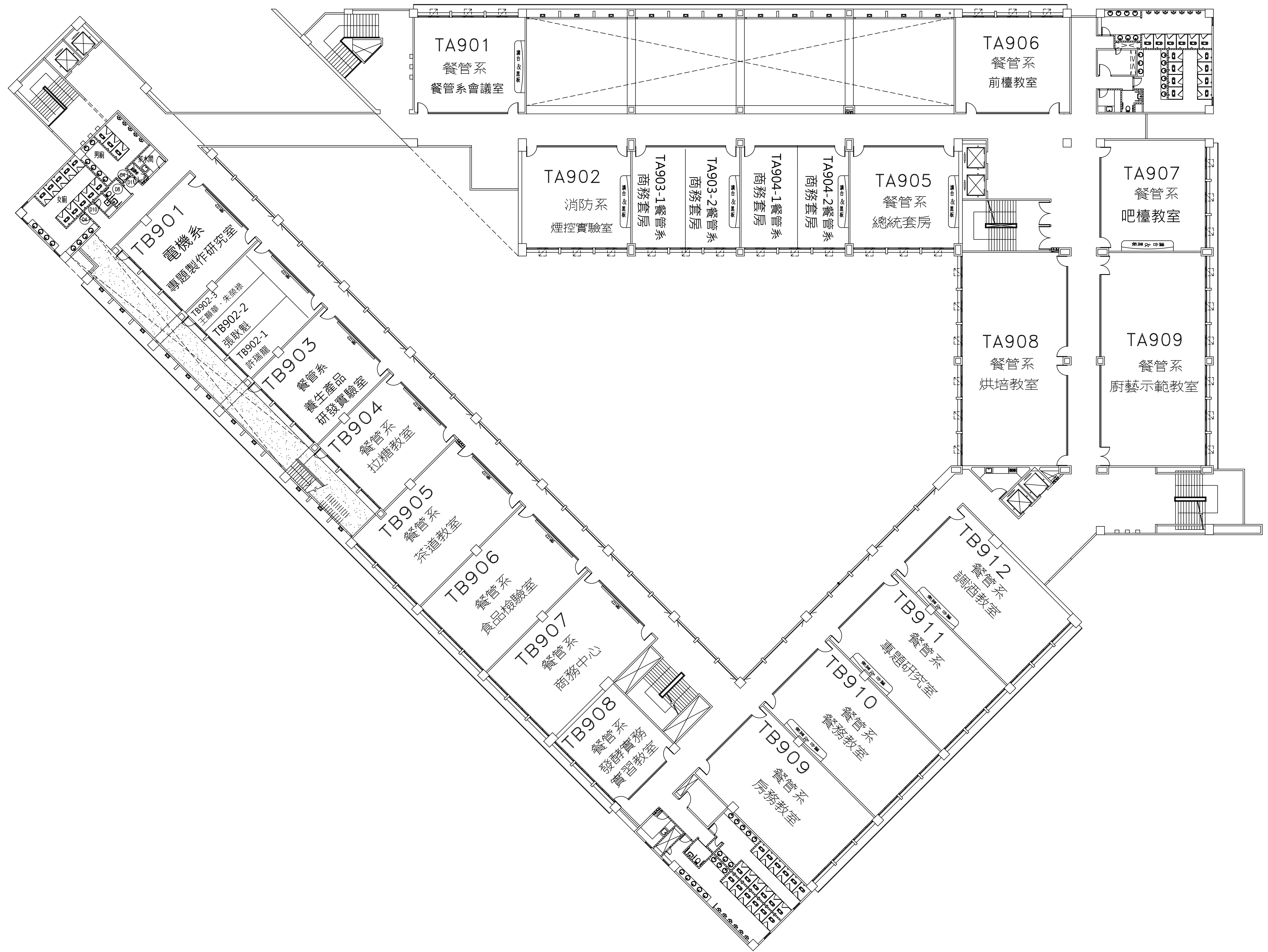

花明樓玖層平面圖

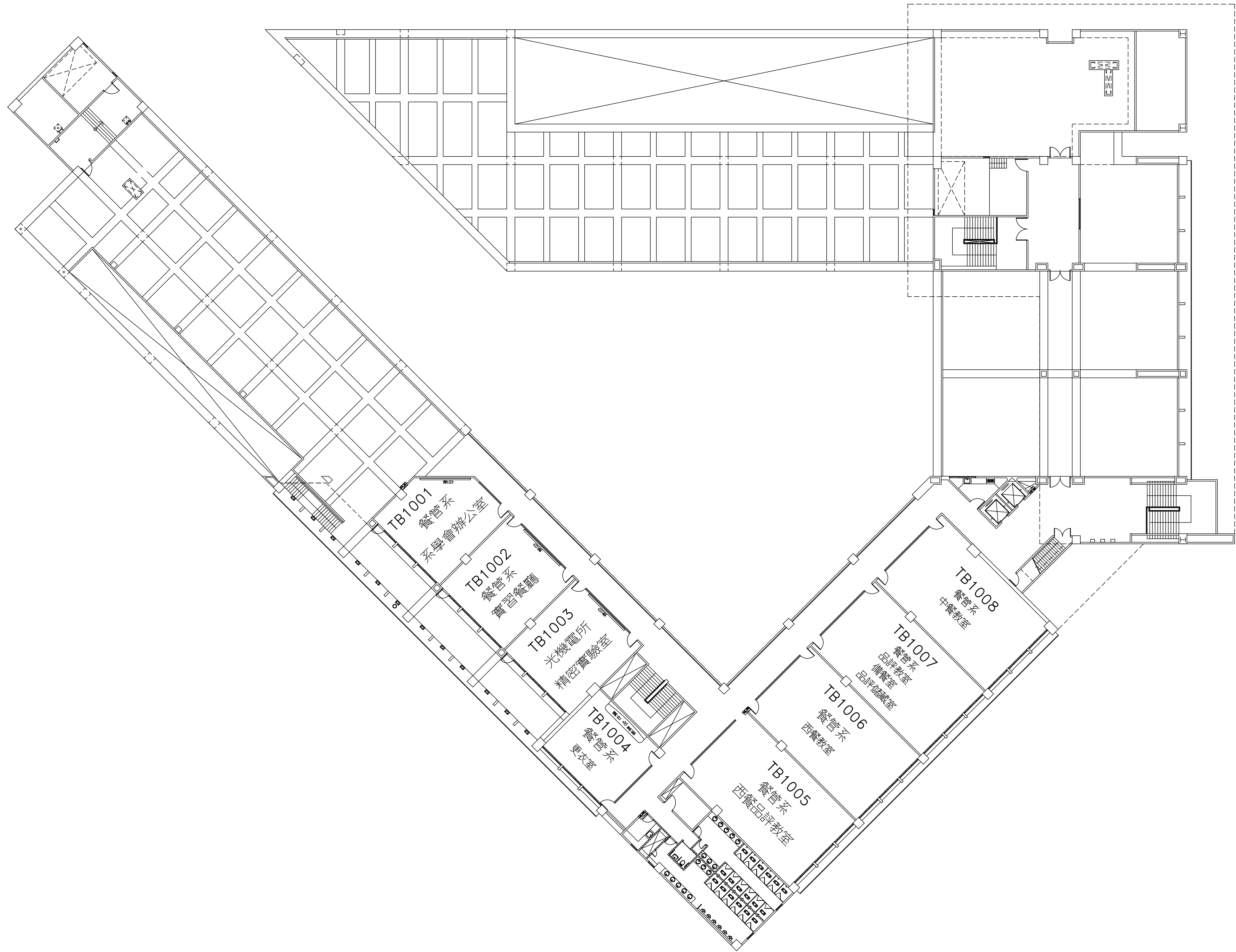

花明樓拾層平面圖